



HERITAGE CAMPUS RENEWAL

Together, let's make a difference.



Foundations

Heritage's roots are deeply embedded in the history of its two founding schools, London Baptist Bible College and Seminary, and Central Baptist Seminary.

Central Baptist Seminary and Bible College began in 1949 in Toronto, while London Baptist Bible College & Seminary began in 1976 in London, Ontario. Heritage College & Seminary was formed in March 1993 from the merger between Central and London.

Heritage College & Seminary seeks to glorify God by partnering with churches in providing a biblically based education; equipping people for life and ministry in the church and in the world.



Current Reality

At Heritage, we believe it is our mission to help reverse the downward trend of church engagement in Canada. We truly believe that our school can have a disproportionate impact on the greater population of Canada by teaching and equipping men and women for life and ministry.

The reality of our situation is that we cannot succeed in our mission without strong support.

Through God's power, your prayers and financial support, we believe we can make a difference.

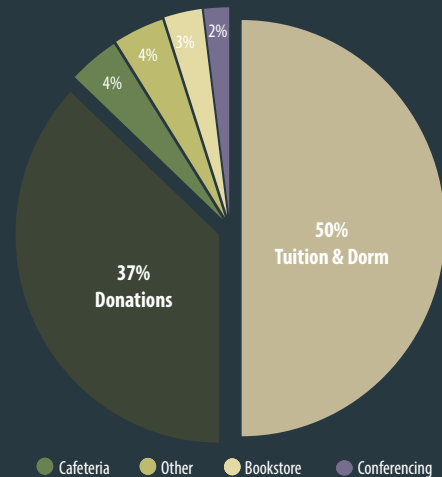

Challenge

Now more than ever, we are competing for the future health of our churches across Canada. It is our desire to equip the church and strengthen it for years to come; however, much like any enterprise, it is imperative to not only maintain our current assets, but make improvements so that we remain a significant option for our students.

Heritage is part of an extremely competitive landscape. We're not only competing in a tough educational market, we are competing for the hearts of men and women to go against the grain of the secular mainstream, to be trained in the Bible, and be open to God's ministry calling on their life.

It is our desire to continue to be a world-class training ground for pastors and ministry leaders in Canada, and we need your help this summer with some practical projects.



There's no doubt that today's student has a greater level of expectation of what should be available on-campus. We have to face our reality; it's a competitive market.



Response

Summer is a time of challenge and opportunity. Summer is typically a time when Heritage is tight on cash, yet it's the best time of year for campus repairs and upgrades.



SUMMER SURGE

This is where our SUMMER SURGE CAMPAIGN comes in. By God's grace, we desire to see this initiative accomplish three primary goals:

1) Upgrade the Campus

Present Heritage as a top-choice school in Canada for those preparing for ministry.

2) Increase our Partnership

Connect and/or reconnect with individuals, churches and foundations in a more meaningful way, through on-campus service projects.

3) Strengthen Fiscal Performance

Expand the number of our faithful supporters, to enable us to thrive for years to come.

External Repairs

Shingle Roof (causing water damage)
Patio Stones (potential safety issue)
\$20k

Student Centre

Renovation to Heritage Student
Centre
\$82k

Dorms

16 Stoves, 16 Fridges
\$18k

Student Services

New Carpet
\$15k

Chapel

New Carpet
Updated Spot Lights
New Projector
New Seating
Updated Sound
\$42k

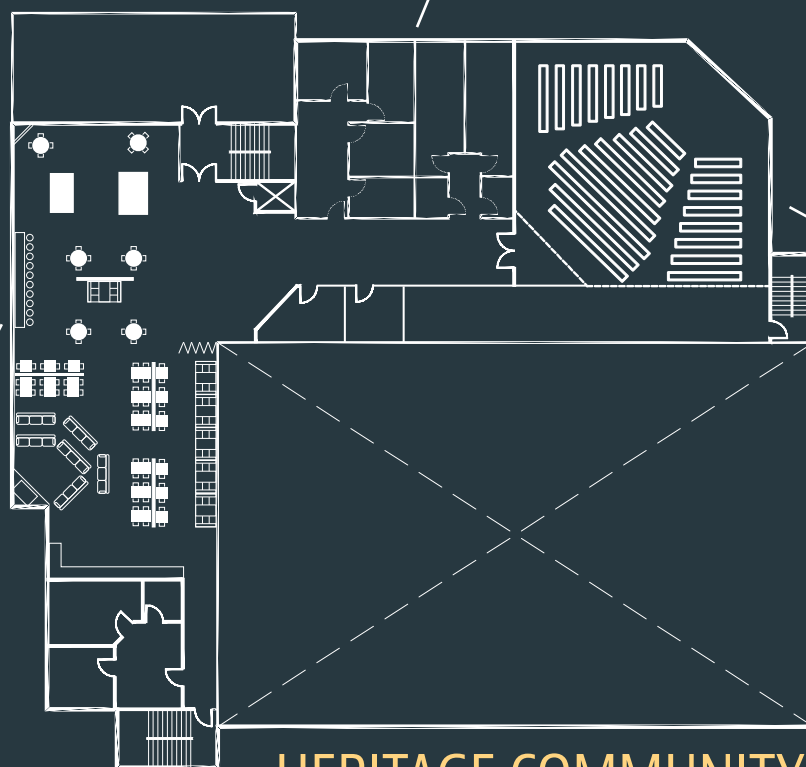

HERITAGE COMMUNITY CENTRE

***We believe we are on a path to greatly impact
the future of the Church in Ontario.***

Will you help us to thrive as we move forward toward this goal?

SUMMER SURGE: By the Numbers

In order to complete necessary repairs, improvements, raise summer operational funds, and attack some of our debt; we need \$325,000 above and beyond our regular monthly donations. The allocation of our Summer Surge Campaign is broken down by:

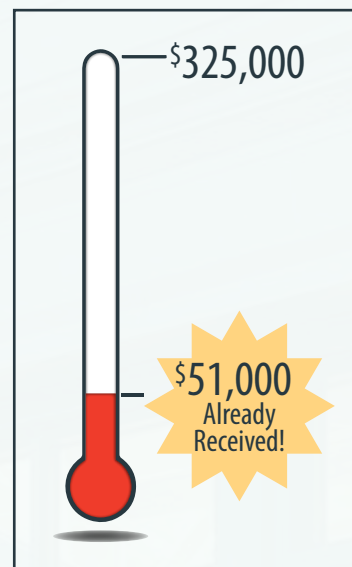

Are you able to help with our SUMMER SURGE in any of the following ways?

Financial Support

For campus improvements, debt reduction, and operations.

Gift Registry

Would you, your church, or your Bible study group, be able to buy a specific item needed in our dorms?

☐ \$500 Stove ☐ \$600 Fridge

Work Projects

For those that want to give in a practical way, we are in need of volunteers this summer.

Would you be able to help with one of our summer service projects?

- ☐ Labour to install patio stones (16 people, heavy lifting required)
- ☐ Landscaping (groups of any size, non-skilled labour)
- ☐ Painting dorm rooms (groups of any size, skilled labour)

See enclosed response card for opportunities to support our SUMMER SURGE project.

...we are competing for the hearts of men and women; to go against the grain of the secular mainstream, to be trained in the Bible and to be open to God's ministry calling on their lives.